



1 & 2 PC FULL BORE FIRE SAFE BALL VALVES

FUSION SERIES

MODELS

T23 Full Port (2PC)
S23 Seal Weld (1PC)

SIZE Range 1/4 thru 4"

1/4 - 2" 2000 WOG
2 1/2 - 4" 1500 WOG

STEAM T23 - 150 SWP
S23 - 250 SWP

API 607-5 CERTIFIED
API 608- COMPLIANCE
NACE MR-01-75

THREADED ENDS

ANSI B1-20-1 NPT
Shell Wall ANSI-B16.34
Testing to 3000 PSI

ANTI-STATIC GROUND
LOCKING HANDLE
OVAL HANDLE
TRACEABILITY
FOUNDRY HEAT # FOR ALL
VALVES
METAL NAME PLATES IDENTIFIES
ALL SOFT PARTS

VALVE BREAK TORQUES

TORQUE NUMBERS INDICATED IN THE CHART ARE TO
BE USED FOR PRESSURES UP TO 1000 PSI
CONSULT FACTORY FOR HIGHER PRESSURES.

SIZE	T23 TORQUE	S23 TORQUE	WEIGHT LBS	C _v
1/2	60	85	.97	15
3/4	80	112	1.35	38
1	95	130	2.25	65
1 1/4	190	265	3.20	118
1 1/2	318	440	5.20	195
2	385	530	8.65	320
2 1/2	480	670	14.77	410
3	800	1100	21.60	640
4	1700	2300	44.75	1660



1" - T23

2 pc Design

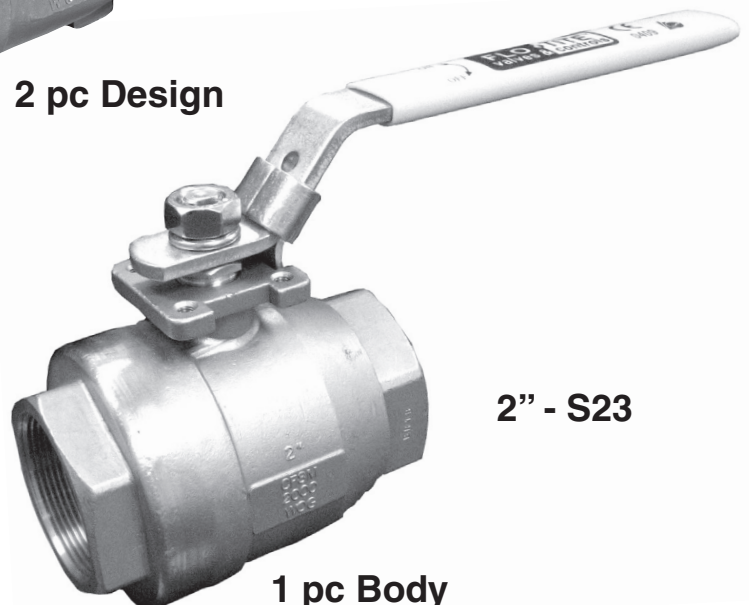

2" - S23

1 pc Body
Seal Welded Design

Seal Weld Design Model S23

Eliminating the possibility of body tail piece unthreading
Eliminating any possible leakage at body joints - safe,
sure pressure containment.

Automatic Welding equipment is used for welding body
joints. The welding width is always uniform and the
weld penetration is consistent. Our equipment main-
tains a consistence water flow inside the valve, this
assures a safe temperature which prevents damage to
all valve seats and seals.

FUSION SERIES

DESIGN & TECHNICAL DATA

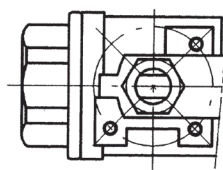
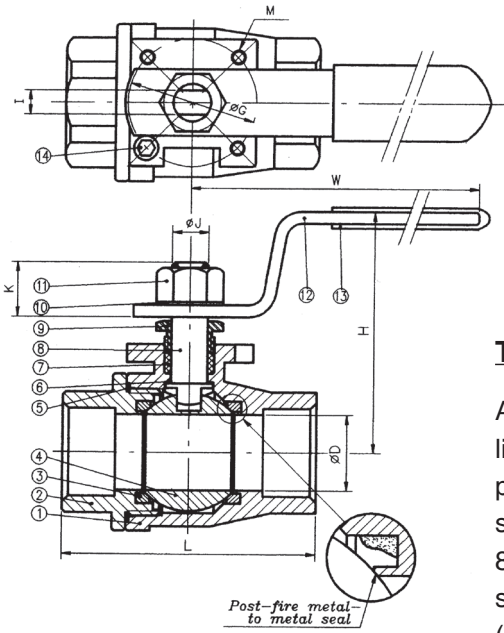

FOR 2 1/2", 3"
* Optional Live Loaded Stem - Consult Factory

TESTING

All valves are factory tested as listed below in open and closed position for bubble tight integrity seat: air under water at 80-100 PSI (MSS-SP-72) shell: Hydrostatic @ 3000 PSI (ANSI-B16.34)

MODELS

T23 Full Port 2 PC
S23 Full Port Seal Weld 1 PC

PRESSURE RATINGS

1/4 - 2" 2000 WOG
2 1/2 - 4" 1500 WOG

STEAM WORKING PRESSURE

T23 - 150 SWP S23 - 250 SWP

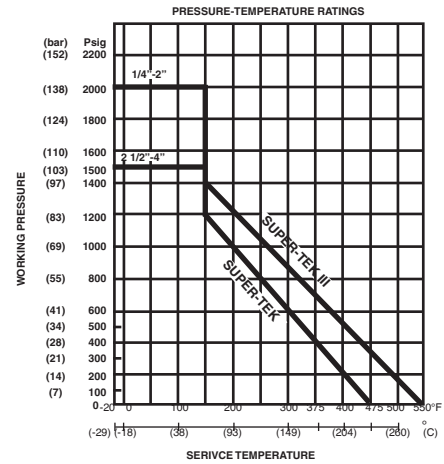

All Valves Are Fire Safe Certified to API 607-5

All Valves Comply With API 608

DIMENSIONS

SIZE		ØD		L		I		ØJ		K		ØG		H		W		M
in	mm	in	mm	in	mm	in	mm	in	mm	in	mm	in	mm	in	mm	in	mm	
1/4"	8	0.43	11	2.32	59	0.20	5	0.31	8	0.35	9	1.42	36	2.17	55	5.31	135	M5
3/8"	10	0.49	12.5	2.32	59	0.20	5	0.31	8	0.35	9	1.42	36	2.17	55	5.31	135	M5
1/2"	15	0.59	15	2.54	64.5	0.20	5	0.31	8	0.45	11.5	1.42	36	2.24	57	5.31	135	M5
3/4"	20	0.79	20	2.87	73	0.24	6	0.39	10	0.59	15	1.42	36	2.46	62.5	5.31	135	M5
1"	25	1.00	25.4	3.37	85.5	0.31	8	0.47	12	0.63	16	1.65	42	2.70	68.5	6.50	165	M5
1 1/4"	32	1.26	32	3.94	100	0.31	8	0.47	12	0.71	18	1.65	42	2.91	74	6.50	165	M5
1 1/2"	40	1.50	38	4.53	115	0.31	8	0.55	14	0.79	20	1.97	50	3.56	90.5	6.89	175	M6
2"	50	1.97	50	5.28	134	0.31	8	0.55	14	0.79	20	1.97	50	3.92	99.5	6.89	175	M6
2 1/2"	65	2.56	65	6.54	166	0.47	12	0.79	20	1.14	29	2.76	70	5.06	128.5	9.57	243	M8
3"	80	3.15	80	7.44	189	0.47	12	0.79	20	1.14	29	2.76	70	5.49	139.5	9.57	243	M8
4"	100	3.94	100	9.09	231	0.63	16	0.98	25	1.22	31	4.02	102	6.59	167.5	10.79	274	M10

Flo-Tite reserve the rights to modify our product design or construction for improvement without prior notice.

MATERIALS LIST

NO.	PARTS	S-23 SS	S-23 CS
1	BODY	ASTM A351-CF8M	ASTM A216-WCB
2	END CAP	ASTM A351-CF8M	ASTM A216-WCB
3	SEAT	SUPER-TEK III	25% CARBON TFM
4	BALL	ASTM A351-CF8M/316	ASTM A351-CF8/304
5	GASKET	GRAPHITE	GRAPHITE
6	THRUST WASHER	GRAPHITE	GRAPHITE
7	STEM PACKING	GRAPHITE	GRAPHITE
8	STEM	ASTM A276-316	ASTM A276-304
9	GLAND	AISI 304	AISI 304
10	HANDLE WASHER	AISI 304	AISI 304
11	HANDLE NUT	AISI 304	AISI 304
12	HANDLE	AISI 304	ZINC PLATED STEEL
13	HANDLE COVER	PVC	PVC
14	STOP SCREW	AISI 304	CARBON STEEL

MATERIALS LIST

NO.	PARTS	T-23 SS	T-23 CS
1	BODY	ASTM A351-CF8M	ASTM A216-WCB
2	END CAP	ASTM A351-CF8M	ASTM A216-WCB
3	SEAT	SUPER-TEK	TFM 1600
4	BALL	ASTM A351-CF8M/316	ASTM A351-CF8/304
5	GASKET	GRAPHITE	GRAPHITE
6	THRUST WASHER		
7	STEM PACKING	GRAPHITE	GRAPHITE
8	STEM	ASTM A276-316	ASTM A276-304
9	GLAND	AISI 304	AISI 304
10	HANDLE WASHER	AISI 304	AISI 304
11	HANDLE NUT	AISI 304	AISI 304
12	HANDLE	AISI 304	ZINC PLATED STEEL
13	HANDLE COVER	PVC	PVC
14	STOP SCREW	AISI 304	CARBON STEEL