



2PC Full Bore Economical Ball Valve

2PC ECONOFLO SERIES

Model : T80SS

1000 WOG / 150 SWP

316 Stainless Steel

Optional Carbon Steel

Temperature Range:

-20 °F to 450 °F

-46 °C to 232 °C

Size Range:

1/4" - 3"

Threaded Ends



DESIGN FEATURES

- Full Port - Straight through flow minimizes pressure drop and prolongs valve life
- Internal Entry Blow-out Proof Stem
- Locking Handle - Standard on all valves meets OSHA 1910.147
- Adjustable V-Ring Stem Packing
- Bubble Tight - Zero Leakage

- Actuator Mounting Pad
- Investment cast improves dimensional control and reduces porosity
- 2PC Econoflo Series is an Ideal General purpose stainless steel valve, meeting plant - wide applications

Econoflo Series offers exceptional economy and proven performance

www.flotite.com

T80SS Full Port Ball Valve Design & Technical Data

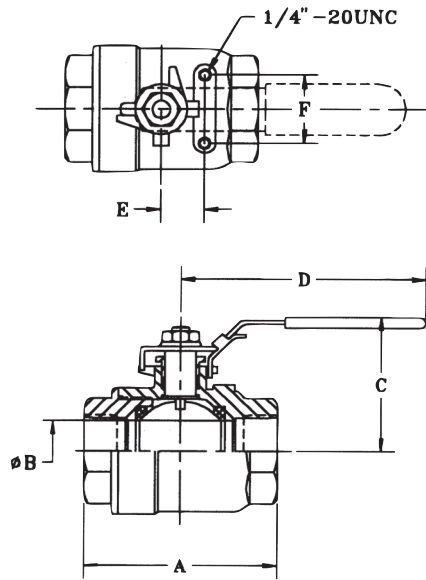

DIMENSIONS AND WEIGHTS:

SIZE	1/4"	3/8"	1/2"	3/4"	1"	1 1/4"	1 1/2"	2"	2 1/2"	3"	
A	in	2.20	2.20	2.52	2.95	3.35	3.86	4.17	4.80	6.38	7.01
	mm	56	56	64	75	85	98	106	122	162	178
φB	in	0.43	0.47	0.59	0.79	0.98	1.26	1.50	1.97	2.56	3.07
	mm	11	12	15	20	25	32	50	65	78	
C	in	1.89	1.89	2.24	2.36	2.80	3.13	3.46	3.86	4.88	5.41
	mm	48	48	57	60	71	79.5	88	98	124	137.5
D	in	3.54	3.54	3.94	4.53	5.51	5.51	7.09	7.48	8.66	9.45
	mm	90	90	100	115	140	140	180	190	220	240
CV		6	7	10	25	35	46	80	110	310	360
Torque (in-lbf)		36	36	65	80	120	235	290	370	685	810
Weight (lbs)		0.66	0.66	0.79	1.28	2.29	3.39	4.97	8.36	15.0	25.5

Dimensions are for estimating purpose only. Please consult factory for exact dimensions.

All valves 100% air tested underwater at 100 psi Open and Close positions.

BILL OF MATERIALS:

ITEM	NAME	T80SS	T80CS	QTY.
1	BODY	ASTM A351 GR. CF8M	ASTM A216 GR. WCB	1
2	END CAP	ASTM A351 GR. CF8M	ASTM A216 GR. WCB	1
3	BALL	ASTM A276 TYPE316	ASTM A276 TYPE316	1
4	SEAT	RPTFE	RPTFE	2
5	BODY SEAL	PTFE	PTFE	1
6	STEM	ASTM A276 TYPE316	ASTM A276 TYPE316	1
7	THRUST WASHER	RPTFE	RPTFE	1
8	STEM PACKING	RPTFE	RPTFE	2
9	GLAND NUT	ASTM A492 TYPE304	CARBON STEEL	1
10	HANDLE	ASTM A167 TYPE304	CARBON STEEL	1
11	LOCKING DEVICE	ASTM A167 TYPE304	CARBON STEEL	1
12	LEVER SLEEVE	VINYL PLASTISOL	VINYL PLASTISOL	1
13	SPRING WASHER	ASTM A492 TYPE304	CARBON STEEL	1
14	NUT	ASTM A492 TYPE304	CARBON STEEL	1

Conforms to:

Federal Specification WW-V-35B
Type II, Class C. Style 3

Pipe Thread in accordance with
ANSI B2 NPT

Drilled and Tapped Actuator
Mounting Pad

PRESSURE AND TEMPERATURE DATA

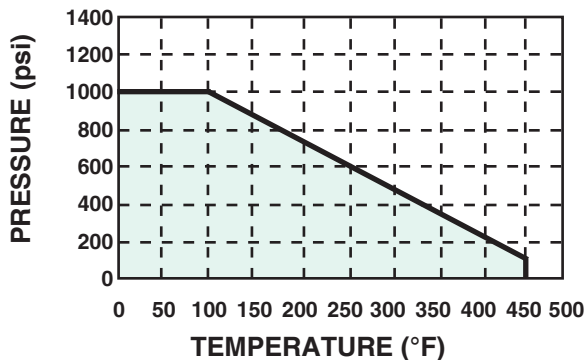

PRESSURE RATING: 1000 WOG

T80 For maximum
Flow Requirements

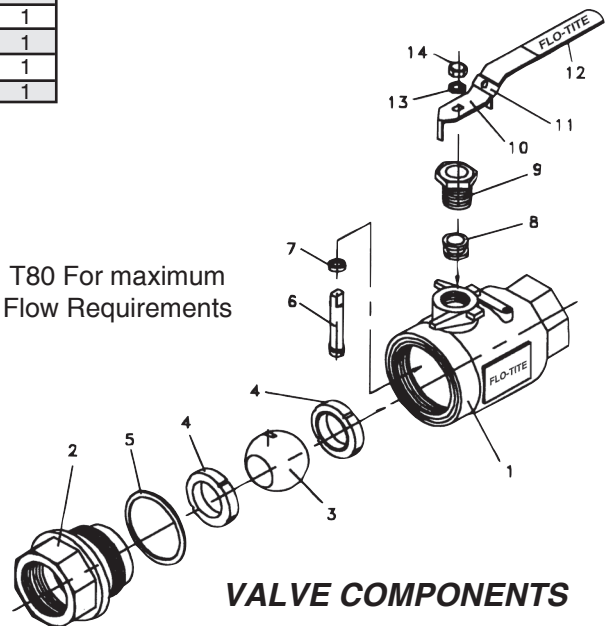

VALVE COMPONENTS